

# T-2420EX Straight Production Screwdriver

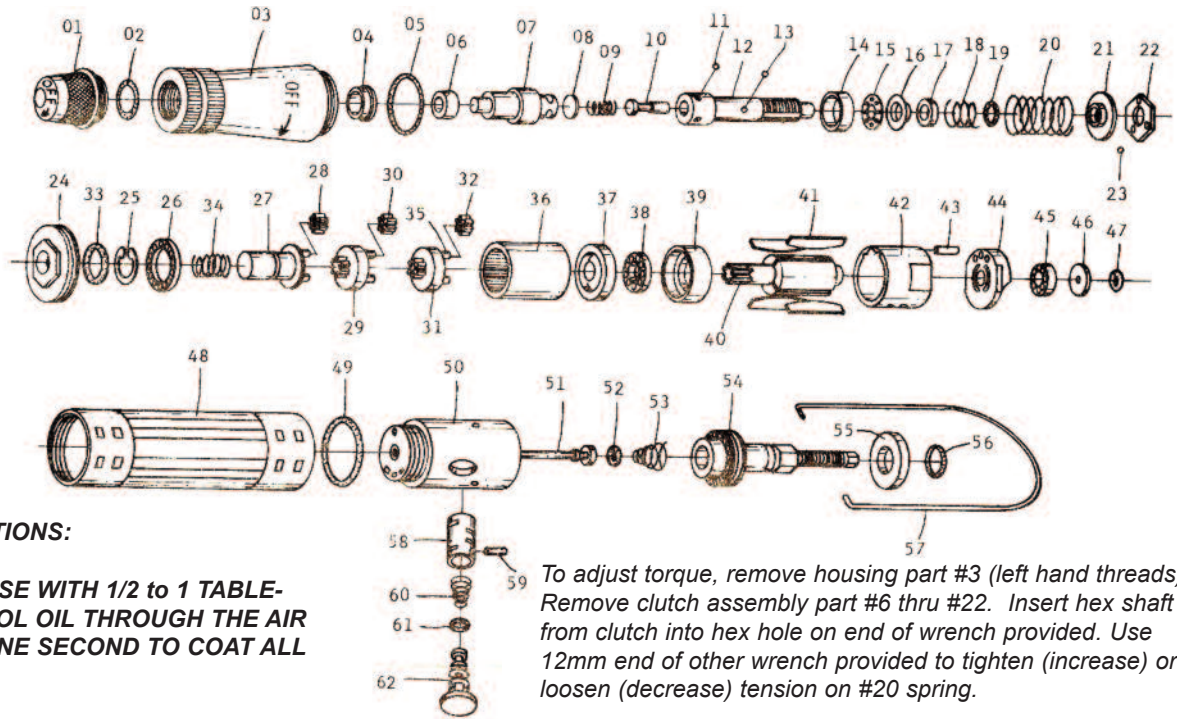

**OILING INSTRUCTIONS:**

**OIL AFTER EACH USE WITH 1/2 to 1 TABLE-  
SPOONS OF AIRTOOL OIL THROUGH THE AIR  
INLET. RUN FOR ONE SECOND TO COAT ALL  
INTERNAL PARTS.**

*To adjust torque, remove housing part #3 (left hand threads).  
Remove clutch assembly part #6 thru #22. Insert hex shaft  
from clutch into hex hole on end of wrench provided. Use  
12mm end of other wrench provided to tighten (increase) or  
loosen (decrease) tension on #20 spring.*

**USE 90 PSI MAXIMUM**

Ref.#	Part #	Description	Qty.
1	2420EX01	Ball Retainer	1
2	02	"O" Ring	1
3	03	Front Housing	1
4	04	Bushing	1
5	05	"O" Ring	1
6	06	Bit Retainer	1
7	07	Anvil	1
8	08	Washer	1
9	09	Spring	1
10	10	Valve Pin	1
11	11	Ball	4
12	12	Body	1
13	13	Ball	3
14	14	Bushing	1
15	15	Washer Bearing	1
16	16	Washer	1
17	17	Release Valve	1
18	18	Spring	1
19	19	"O" Ring	1
20	20	Spring	1
21	21	Washer	1
22	22	Nut	1
23	23	Ball	3
24	24	Nut	1
25	25	Retaining Ring	1
25	26	Bearing	1
27	27	Spindle	1
28	28	Gear	3
29	29	Gear Carrier	1
30	30	Gear	3

Ref.#	Part #	Description	Qty.
31	2420EX31	Gear Carrier	1
32	32	Gear	3
33	33	"O" Ring	1
34	34	Spring	1
35	35	Pin	9
36	36	Ring Gear	1
37	37	Washer	1
38	38	Bearing	1
39	39	Front End Plate	1
40	40	Rotor	1
41	41	Vanes	4
42	42	Cylinder	1
43	43	Pin	1
44	44	Rear End Plate	1
45	45	Bearing	1
46	46	Washer	1
47	47	"O" Ring	1
48	48	Handle	1
49	49	"O" Ring	1
50	50	Valve Body	1
51	51	Pin	1
52	52	"O" Ring	1
53	53	Spring	1
54	54	Air Inlet	1
55	55	Exhaust Cover	1
56	56	"O" Ring	1
57	57	Bail	1
58	58	Reverse Bushing	1
59	59	Pin	1
60	60	Spring	1
61	61	"O" Ring	1
62	62	Valve Stem	1

505 N. Railroad Ave.  
P.O. Box 1117  
Boynton Beach, Florida 33435

**SEE OUR CATALOG**  
at  
[www.taylorpneumatic.com](http://www.taylorpneumatic.com)

PH. 561-732-1111  
FAX 561-731-4412  
Toll Free 800-805-8665