

1/4" Palm Drill With Teasing Throttle

T-9888, T-9888R, T-9888K, T-9888RK, T-9888MK, T-9888SPC, T-9888RSPC



"R" in model # = Reversible

T-988834
Taylor 1/4"
High Quality
Chuck & Key

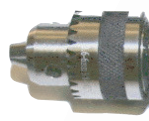

T-9888-MKC
1/4" Metal
Keyless Chuck



T-9888-SPC
1/4" Special Hi-
Performance
Chuck & Key



T-9888-KC
1/4" Composite
Keyless Chuck

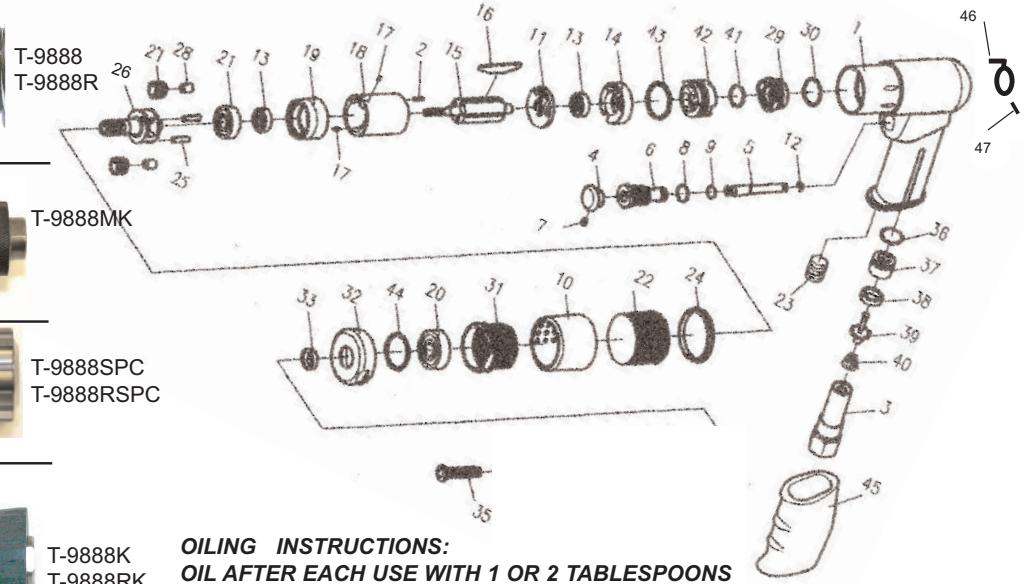
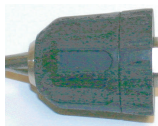

OILING INSTRUCTIONS:
OIL AFTER EACH USE WITH 1 OR 2 TABLESPOONS
OF AIRTOOL OIL THROUGH THE AIR INLET. RUN
FOR ONE SECOND TO COAT ALL INTERNAL PARTS.

USE 90 PSI MAXIMUM

Ref.#	Part #	Description	Qty.
1	9888R01	Motor Housing (Rev.)	1
1A	988801	Motor Housing	1
2	988802	Spring Pin	1
3	988803	Air Inlet	1
4	988804	Trigger	1
5	988805	Valve Stem	1
6	988806	Valve Bushing	1
7	988807	Set Screw	1
8	988808	"O" Ring	1
9	988809	"O" Ring	1
10	988810	Exhaust Deflector	1
11	988811	Rear End Plate	1
11A	9888R11	End Plate	1
12	988812	E-Ring	1
13	988813	Bearing	2
14	988814	Plate	1
14A	9888R14	Plate	1
15	988815	Rotor	1
16	988816	Rotor Blades (5 per set)	1 set
17	988817	Spring Pin	2
18	988818	Cylinder	1
19	988819	Front End Plate	1
20	988820	Bearing	1
21	988821	Bearing	1
22	988822	Filter	1
23	988823	Set Screw	1
24	988824	Rubber Ring	1

Ref.#	Part #	Description	Qty.
25	988825	Pin	2
26	988826	Cage	1
26A	9888R26	Cage	1
27&28	988827/28	Gear & Bushing	2
29	988829	Valve	1
29A	9888R29	Reverse Valve	1
30	9888R30	"O" Ring	1
31	988831	Ring Gear	1
32	988832	Clamp Nut	1
33	988833	Washer	1
35	9888R35	Screw	1
36	988836	"O" Ring	1
37	988837	Valve Seat	1
38	988838	Rubber Seal	1
39	988839	Valve Stem	1
40	988840	Spring	1
41	9888R41	"O" Ring	1
42	988842	Valve	1
42A	9888R42	Reverse Valve	1
43	988843	"O" Ring	1
44	988844	"O" Ring	1
45	988845	Rubber Grip	1
46	9888R46	Reverse Lever	1
47	9888R47	Set Screw	1

505 N. Railroad Ave.
P.O. Box 1117
Boynton Beach, Florida 33435

SEE OUR CATALOG
at
www.taylorpneumatic.com

PH. 561-732-1111
FAX 561-731-4412
Toll Free 800-805-8665

12/08 TPTCDPT
all rights reserved
COPYRIGHT 2008
final