

T-7764EX 1/4" Screwdriver

800 RPM

Taylor
Pneumatic Tool Company

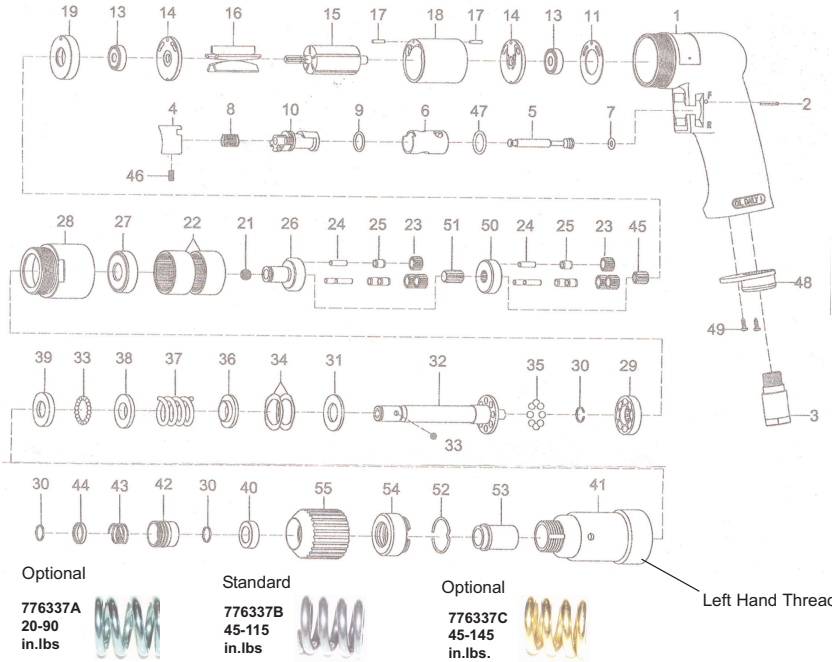

OILING INSTRUCTIONS:

OIL AFTER EACH USE WITH 1 OR 2 TABLE-SPOONS OF AIRTOOL OIL THROUGH THE AIR INLET. RUN FOR ONE SECOND TO COAT ALL INTERNAL PARTS.

SEE OUR CATALOG at www.taylorpneumatic.com

USE 90 PSI MAXIMUM

Ref.#	Part #	Description	Qty.
1	776301	Housing	1
1A	776301A	Complete Housing	1
2	776302	Pin	1
3	776303	Air Inlet	1
4	776304	Trigger	1
5	776305	Valve Stem	1
6	776306	Reverse Bushing	1
7	776307	"O" Ring	1
8	776308	Valve Spring	1
9	776309	"O" Ring	1
10	776310	Reverse Lever	1
11	776311	Motor Gasket	1
13	776313	Bearing	2
14	776314	End Plate	2
15	776315	Rotor	1
16	776316	Rotor Blade (5 per set)	1 set
17	776317	Pin	2
18	776318	Cylinder	1
19	776319	Spacer	1
21	7763EX21	Ball	1
22	776322	Internal Gear	2
23	7764EX23	Planet Gear	6
24	776324	Pin	6
25	7764EX25	Bushing	6
26	7764EX26	Spindle	1
27	7764EX27	Bearing	1
28	7764EX28	Clamp Nut	1

Ref.#	Part #	Description	Qty.
29	7763EX29	Drive Dog	1
30	776330	Retainer Ring	3
31	7763EX31	Thrust Washer	1
32	7763EX32	Cam Spindle	1
33	776333	Ball	16
34	7763EX34	Wave Washer	2
35	7763EX35	Ball	8
36	7763EX36	Washer	1
37	776337B	Spring (standard)	1
38	7763EX38	Washer	1
39	7763EX39	Ball Guide	1
40	776340	Spacer	1
41	7764EX41	Clutch Housing	1
42	776342	Ball Retainer	1
43	776343	Spring	1
44	7764EX44	Washer	1
45	7764EX45	Pinion Gear	1
46	776346	Set Screw	1
47	776347	"O" Ring	1
48	776348	Exhaust Diffuser	1
49	776349	Screw	2
50	7764EX50	Spindle	1
51	7764EX51	Center Gear	1
52	7763EX52	Retainer	1
53	7763EX53	Bushing	1
54	7763EX54	Adjustable Screw	1
55	7763EX55	Adjustable Knob	1

505 N. Railroad Ave. P.O. Box 1117
Boynton Beach, Florida 33435

PH. 561-732-1111 FAX 561-731-4412
Toll Free 800-805-8665

07/09 TPTCDPT
all rights reserved
COPYRIGHT 2009
final